



TBI Industries

TBi 150 (FX) Expert Mini

Kühlart / Cooling method	Belastbarkeit [A] / Rating [A] Max. (M21) / CO ₂	Einschaltdauer / Duty cycle (10 min)	Draht-Ø / Wire diam. [mm]
Gas / gas	TBi 150: 150 / 160 TBi 150 FX: 150 / 155	60 %	0.6 - 1.0

Typ / Type	Anschluss / Connector	Biegung / Bend	Brennerhals / Torch neck	Anschlussmutter / Adapter nut	Art. Nummer / Part no.
▶ TBi 150 Expert Mini	Euro	50°	—	Basic-Version	102P3510_0*
TBi 150 Expert Mini	Euro	50°	—	Messing / brass	102P7510_0*
TBi 150 FX Expert Mini	Euro	—	flexibel / flexible	Messing / brass	102P3510_F*

Stromdüsen / Contact tips

▶ M6x25, ECu	340P__1073*
M6x25, CuCrZr	340P__3073*
M6x25 Alu, ECu	341P__1073*

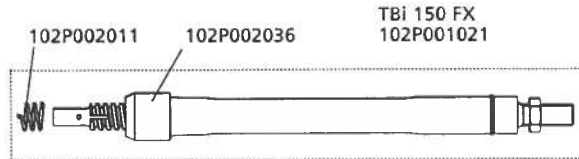

Gasdüsen / Gas nozzles

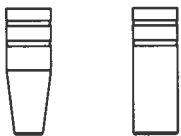

NW 9.5
345P013002



NW 16
345P011002

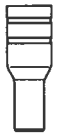

NW 12.5
345P014002



NW 16
345P015402



NW 16
345P015502

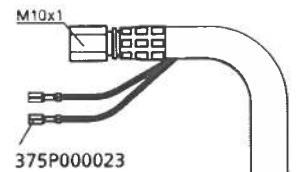
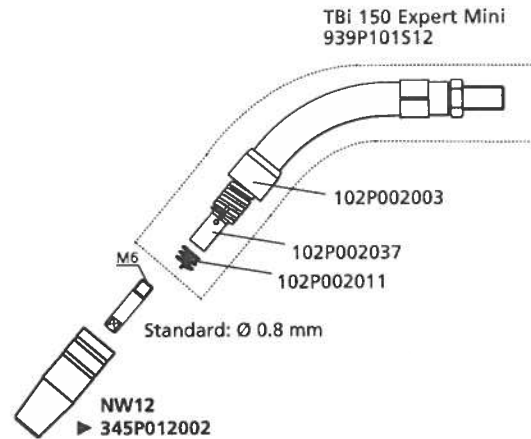

Koaxkabel TBi ProFlex S
Coaxial cable TBi ProFlex S
3m: 359P145130
4m: 359P145140
5m: 359P145150

ESG kpl. / ESG cpl.
701P001048

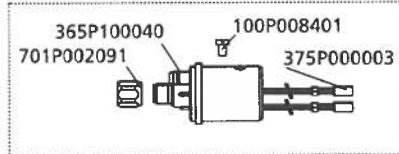

▶ 700P002161 (Basic-Version)
700P001010 (Messing / brass)

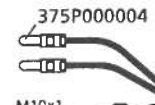
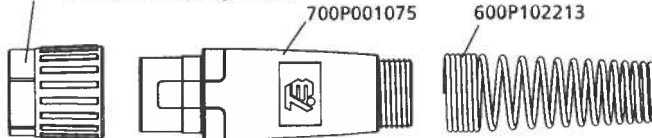

Griffschale kpl. / Handle cpl. kit
380P020001

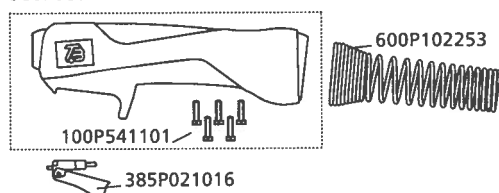

Drahtführungen / Wire guides

	m	Ø 0.6 - 0.9	Ø 0.8 - 1.0
Drahtführungsspirale für Stahldraht Liner for steel wire		weiß / white	blau / blue
	3	324P133834	▶ 324P154534
	4	324P133844	▶ 324P154544
	5	324P133854	▶ 324P154554
PTFE-Seele für Alu- und Edelstahldraht PTFE liner for alu- and stainless steel wire			blau / blue
	3	—	326P154035
	4	—	326P154045
	5	—	326P154055

▶ Standard / Standard

*Bitte an Leerstelle entsprechende Angaben für Brennerlänge oder Drahtdurchmesser einsetzen, z.B. 08 für 0.8 mm oder 3 für 3 m. / At the blank, please insert suitable information for torch length or wire diameter, e.g. 08 for 0.8 mm or 3 for 3 m.