

Kühlart / Cooling method	Belastbarkeit [A] / Rating [A] Mix (M2i) CO2	Einschaltdauer / Duty cycle (10 min.)	Draht-Ø / Wire diam. [mm]
Wasser / water	450 500	100 %	1.0 - 1.6

Typ / Type	Anschluss / Connector	Biegung / Bend	Art. Nummer / Part no.
TBi 411 Expert	Euro	50°	133P4210_0*

Düsenstock / Tip holder

M8 / L=25 mm	342P008033
M8 / L=29 mm	342P008133
M6 / L=25 mm	342P006033
M6 / L=29 mm	342P006133

Gasverteiler / Gas diffusers

Schwarz / Black	130P002026
Keramik / Ceramic	130P002019

Stromdüsen / Contact tips

M8x30, Ecu	340P__1262*
M8x30, CuCrZr	340P__3262*
M8x30 Alu, Ecu	341P__1262*
M6x28, Ecu	340P__1069*
M6x28, CuCrZr	340P__3069*
M6x28 Alu, Ecu	341P__1069*

Gasdüsen / Gas nozzles

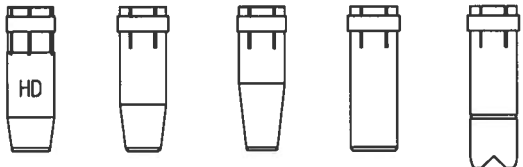

NW 16 HD	NW 14	NW 12	NW 20	NW 20
345P012032	345P013030	345P016030	345P011030	345P015030
		nur für M6 / only for M6		

ESW kpl. / ESW cpl.

701P001049

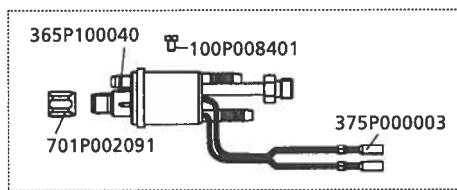

Griffschale ,Expert' kpl. / Handle kit ,Expert' cpl.

380P230003

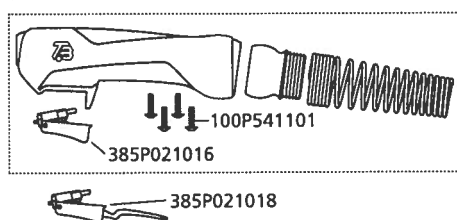

Standard / Standard

*Bitte an Leerstelle entsprechende Angaben für Brennerlänge oder Drahtdurchmesser einsetzen, z.B. 08 für 0.8 mm oder 3 für 3 m.
At the blank, please insert suitable information for torch length or wire diameter, e.g. 08 for 0.8 mm or 3 for 3 m.

TBi 411 133P001001

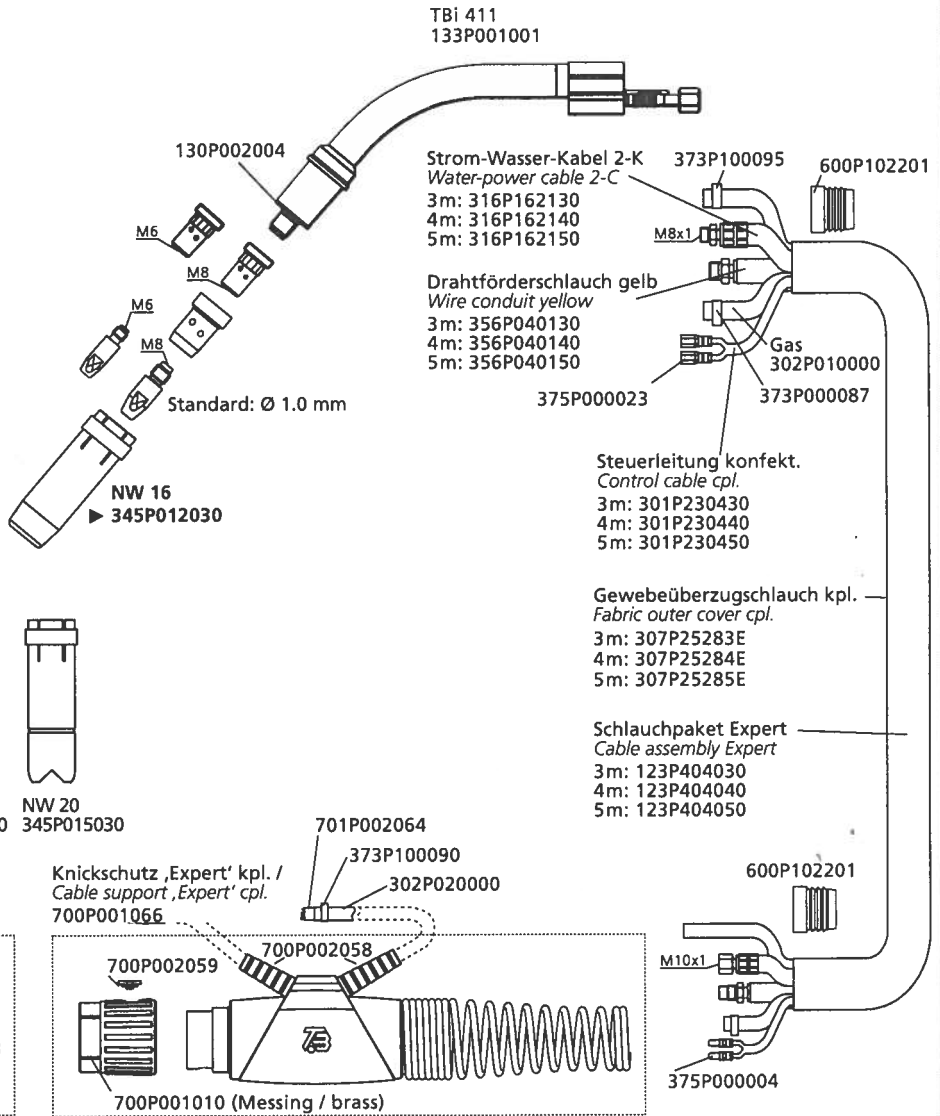

Drahtführungen / Wire guides

	m	Ø 0.8 - 1.0	Ø 1.0 - 1.2	Ø 1.2 - 1.6
Drahtführungsspirale für Stahldraht Liner for steel wire			blank / not insul.	blank / not insul.
	3	—	▶ 322P204534	322P254534
	4	—	▶ 322P204544	322P254544
	5	—	▶ 322P204554	322P254554
PTFE-Seele für Alu- und Edelstahldraht PTFE liner for alu- and stainless steel wire			rot / red	gelb / yellow
	3	—	326P204035	326P274735
	4	—	326P204045	326P274745
	5	—	326P204055	326P274755
PA-Seele mit Bronzespirale für Aludraht PA liner with bronze liner for alu wire		anthrazit / anthracite		anthrazit / anthracite
	3	328P20403A	—	328P23473A
	4	328P20404A	—	328P23474A
	5	328P20405A	—	328P23475A