

Kühlart / Cooling method	Belastbarkeit (A) / Rating (A) CO ₂		Einschaltdauer / Duty cycle (10 min)	Draht-Ø / Wire diam [mm]
Gas / gas	300	330	60 %	1.0 - 1.6

Typ / Type	Anschluss / Connector	ausgerüstet mit / fitted for	Biegung / Bend	Art. Nummer / Part no.
▶ TBi 360 Expert	Euro	M6	50°	114P3210_0*
▶ TBi 360 Expert	Euro	M8	50°	114P3B10_0*

Düsenstock / Tip holder



▶ M6 / L=28 mm	342P006014
M6 / L= 32 mm	342P006114
▶ M8 / L= 28 mm	342P008014
M8 / L= 34 mm	342P008114

Gasverteiler / Gas diffusers



▶ Schwarz / Black	114P002007
Keramik / Ceramic	114P002005

Stromdüsen / Contact tips



▶ M6x28, ECu	340P__1069*
M6x28, CuCrZr	340P__3069*
M6x28 Alu, Ecu	341P__1069*
▶ M8x30, ECu	340P__1262*
M8x30, CuCrZr	340P__3262*
M8x30 Alu, Ecu	341P__1262*

Gasdüsen / Gas nozzles



NW 12 345P013010
NW 20 345P011010
NW 20 345P015010
nur für M6 /
only for M6

ESG kpl. / ESG cpl.

701P001048

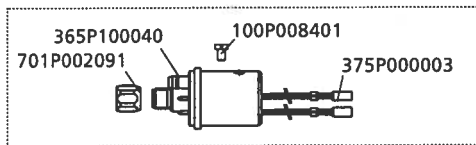

Griffschale „Expert“ kpl. / Handle kit „Expert“ cpl.

380P230001

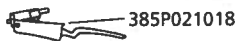
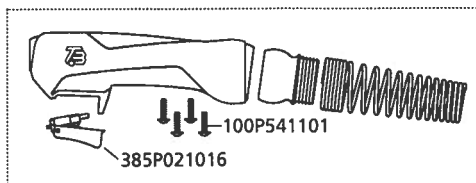

▶ Standard / Standard

*Bitte an Leerstelle entsprechende Angaben für Brennerlänge oder Drahtdurchmesser einsetzen, z.B. 08 für 0.8 mm oder 3 für 3 m.
At the blank, please insert suitable information for torch length or wire diameter, e.g. 08 for 0.8 mm or 3 for 3 m.

Standard: Ø 1.2 mm

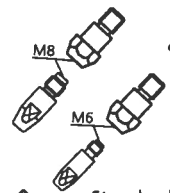

NW 16
345P012010

700P001010
(Messing / brass)

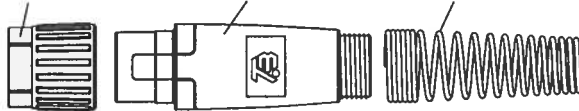

101P002005

Drahtführungen / Wire guides

	m	Ø 0.8 - 1.0	Ø 1.0 - 1.2	Ø 1.2 - 1.6
Drahtführungsspirale für Stahldraht Liner for steel wire			rot / red	gelb / yellow
	3	—	▶ 324P204534	324P254534
	4	—	▶ 324P204544	324P254544
	5	—	▶ 324P204554	324P254554
PTFE-Seele für Alu- und Edelstahldraht PTFE liner for alu- and stainless steel wire			rot / red	gelb / yellow
	3	—	326P204035	326P274735
	4	—	326P204045	326P274745
	5	—	326P204055	326P274755
PA-Seele mit Bronzespirale für Aludraht PA liner with bronze liner for alu wire		anthrazit / anthracite		anthr. / anthracite
	3	328P20403A	—	328P23473A
	4	328P20404A	—	328P23474A
	5	328P20405A	—	328P23475A

TBi 360
114P001001 600P002018

M10x1

375P000023

Koaxkabel ProfFlex L
Coaxial cable ProfFlex L
3m: 361POL1130
4m: 361POL1140
5m: 361POL1150

375P000004

M10x1