

Kühlart / Cooling method	Belastbarkeit [A] / Rating [A] Mix (M21) / CO ₂	Einschaltdauer / Duty cycle (i0 min.)	Draht-Ø / Wire diam. [mm]
Gas / gas	TBi 250: 210 / 230 TBi 250 FX: 200 / 230	60 %	0.8 - 1.2

Typ / Type	Anschluss / Connector	Biegung / Bend	Brennerhals / Torch neck	Art. Nummer / Part no.
► TBi 250 Expert Mini	Euro	50°	—	104P3510_0*
TBi 250 FX Expert Mini	Euro	—	flexibel / flexible	104P3510_F*

Düsenstock / Tip holder

► M6 / L=35 mm	342P006003
M8 / L=35 mm	342P008003

Stromdüsen / Contact tips

► M6x28, ECu	340P__1069*
M6x28, CuCrZr	340P__3069*
M6x28 Alu, ECu	341P__1069*
M8x30, ECu	340P__1262*
M8x30, CuCrZr	340P__3262*
M8x30 Alu, ECu	341P__1262*

Gasdüsen / Gas nozzles

NW 11
345P013003

NW 20
345P011303

NW 14
345P014003

NW 18
345P015503

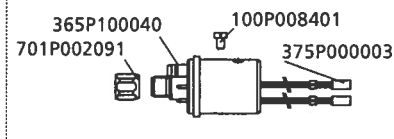
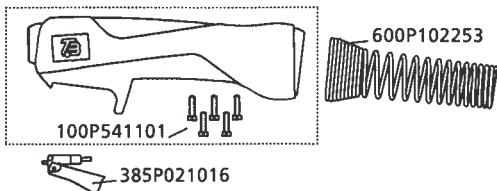

ESG kpl. / ESG cpl.
701P001048

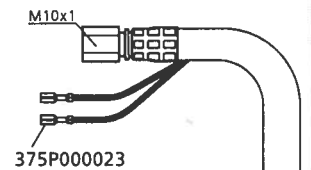
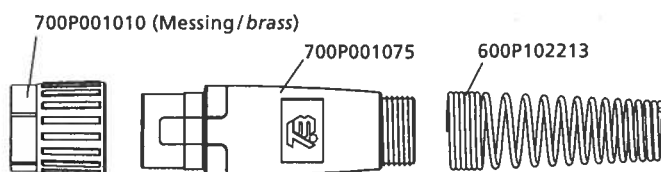
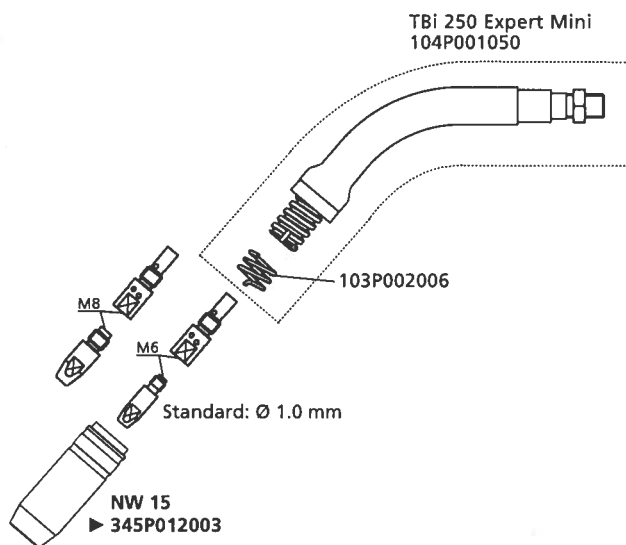
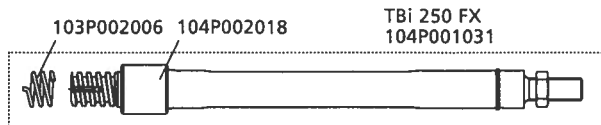
Griffschale kpl. / Handle cpl. kit
380P020001

► Standard / Standard

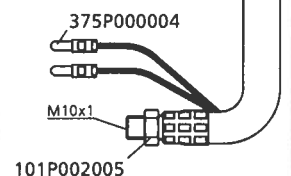
*Bitte an Leerstelle entsprechende Angaben für Brennerlänge oder Drahtdurchmesser einsetzen, z.B. 08 für 0.8 mm oder 3 für 3 m. / At the blank, please insert suitable information for torch length or wire diameter, e.g. 08 for 0.8 mm or 3 for 3 m.



Koaxkabel ProFlex M
Coaxial cable ProFlex M
3m: 361P0M5130
4m: 361P0M5140
5m: 361P0M5150

Drahtführungen / Wire guides

	m	Ø 0.8 - 1.0	Ø 1.0 - 1.2
Drahtführungsspirale für Stahldraht Liner for steel wire		blau / blue	rot / red
	3	324P154534	► 324P204534
	4	324P154544	► 324P204544
	5	324P154554	► 324P204554
PTFE-Seele für Alu- und Edelstahldraht PTFE liner for alu- and stainless steel wire		blau / blue	rot / red
	3	326P154035	326P204035
	4	326P154045	326P204045
	5	326P154055	326P204055
	m	Ø 0.8 - 1.0	Ø 1.2
PA-Seele mit Bronzespirale für Aludraht PA liner with bronze liner for alu wire		anthrazit / anthracite	anthrazit / anthracite
	3	328P20403A	328P23473A
	4	328P20404A	328P23474A
	5	328P20405A	328P23475A